



FOR SALE - \$7,575,000

NOI

First Year: \$303,000

Overall: \$322,000

CAP Rate

4.0%

4.25%

SEC Ramsey Rd. & Marie Ave.

Coeur d'Alene, ID

- Two free-standing buildings on 53,000± sf hard corner pad
- Starbucks: 2,000± sf - 10 Year Lease
- MultiCare-Indigo Urgent Care; 4,415± sf - 15 Year Lease - BTS in construction
- Anchored by 72,000± sf WinCo Foods
- Immediate proximity to I-90 Fwy. Exchange via Ramsey Rd.
- Multiple left turn access points
- Major Signals at Ramsey Rd/Appleway & Ramsey Rd. & Marie Ave. **Over 50,000 combined ADT**
- **Click [HERE](#) to view Site Aerial Video**

Broker contact:

Steve Ridenour

+1 208 660 5010 mobile

sridenour@naiblack.com

KC Reese

+1 208 755 7629 mobile

kc.reese@naiblack.com

105 N 1st St., Ste 300,
Coeur d'Alene, ID 83814



Click [HERE](#) to View Aerial Video

NO WARRANTY OR REPRESENTATION, EXPRESS OR IMPLIED, IS MADE AS TO THE ACCURACY OF THE INFORMATION CONTAINED HEREIN, AND THE SAME IS SUBMITTED SUBJECT TO ERRORS, OMISSIONS, CHANGE OF PRICE, RENTAL OR OTHER CONDITIONS, PRIOR SALE, LEASE OR FINANCING, OR WITHDRAWAL WITHOUT NOTICE, AND OF ANY SPECIAL LISTING CONDITIONS IMPOSED BY OUR PRINCIPALS NO WARRANTIES OR REPRESENTATIONS ARE MADE AS TO THE CONDITION OF THE PROPERTY OR ANY HAZARDS CONTAINED THEREIN ARE ANY TO BE IMPLIED.

NAIBlack

Steve Ridenour

105 North 1st Street, Suite 300
Coeur d'Alene, Idaho 83814
208.660.5010 mobile
sridenour@naiblack.com

801 W. Riverside Ave.
Spokane, WA 99201
509.623.1000
naiblack.com

W MARIE AVE

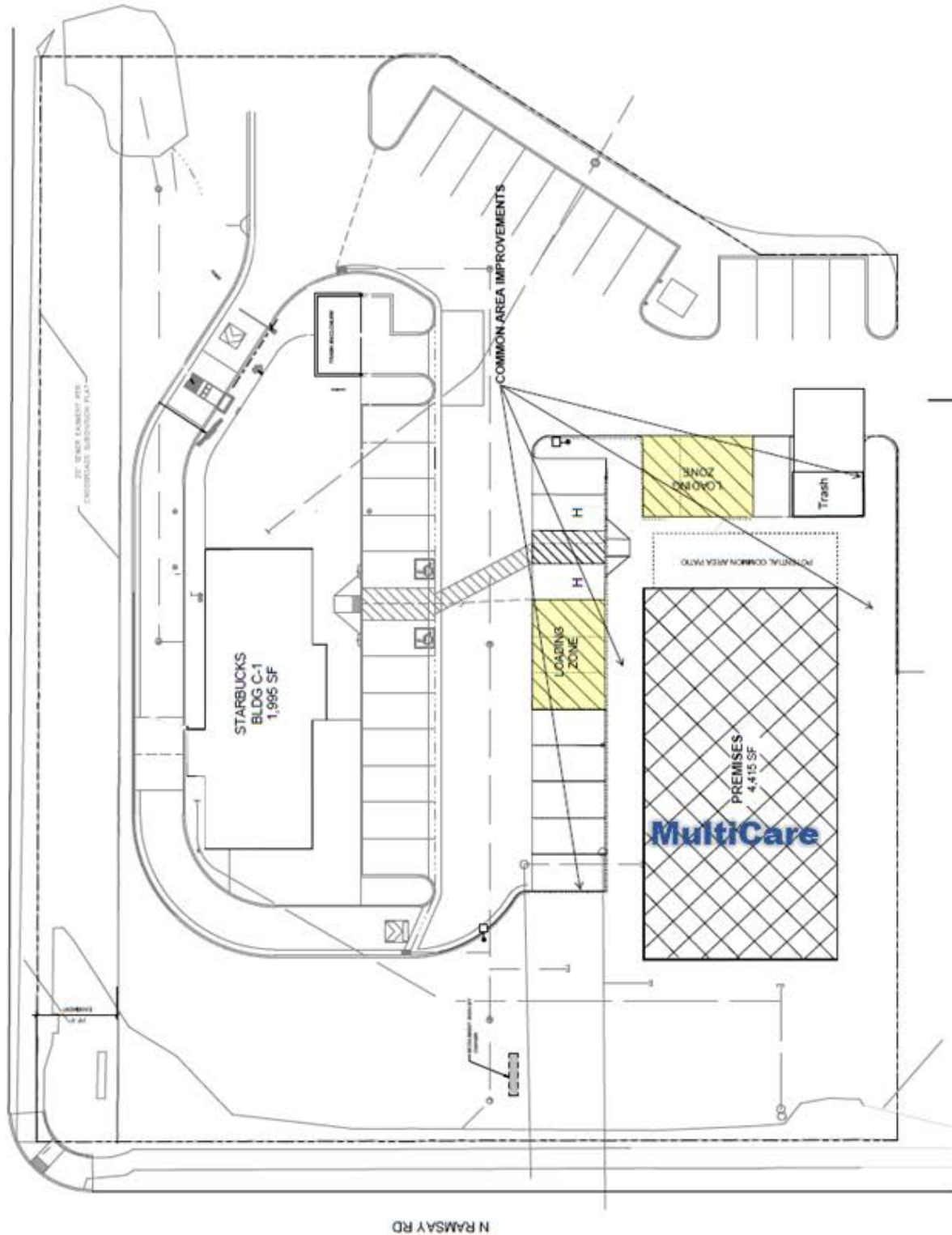

NO WARRANTY OR REPRESENTATION, EXPRESS OR IMPLIED, IS MADE AS TO THE ACCURACY OF THE INFORMATION CONTAINED HEREIN, AND THE SAME IS SUBMITTED SUBJECT TO ERRORS, OMISSIONS, CHANGE OF PRICE, RENTAL OR OTHER CONDITIONS, PRIOR SALE, LEASE OR FINANCING, OR WITHDRAWAL WITHOUT NOTICE, AND OF ANY SPECIAL LISTING CONDITIONS IMPOSED BY OUR PRINCIPALS NO WARRANTIES OR REPRESENTATIONS ARE MADE AS TO THE CONDITION OF THE PROPERTY OR ANY HAZARDS CONTAINED THEREIN ARE ANY TO BE IMPLIED.

NAI Black

Steve Ridenour

105 North 1st Street, Suite 300
Coeur d'Alene, Idaho 83814
208.660.5010 mobile
sridenour@naiblack.com

801 W. Riverside Ave.
Spokane, WA 99201
509.623.1000
naiblack.com