



Taco Bell

1007 N Commerce St, Ardmore, Oklahoma 73401

OFFERING MEMORANDUM

partners

PARTNERS

+ 512 580 6025

901 S MoPac Expy, Bldg 1, Ste 550

Austin, Texas USA 78746

PARTNERSREALESTATE.COM

HOUSTON

+ 713 629 0500
1360 Post Oak Blvd, Suite 1900
Houston, TX 77056

AUSTIN

+1 512 580 6025
901 South MoPac Expressway
Building 1, Suite 550
Austin, TX 78746

SAN ANTONIO

+1 210 446 3655
1020 NE Loop 410, Suite 810
San Antonio, TX 78209

DALLAS

+1 214 550 2990
1717 McKinney Ave, Suite 1480
Dallas, TX 75202

PARTNERS CONTACT:



Jonathan Eckerd
SENIOR VICE PRESIDENT

tel 713.316.7031
jonathan.eckerd@partnersrealestate.com



Caleb Bester
ASSOCIATE

tel 713.457.1403
caleb.bester@partnersrealestate.com

DISCLAIMER

This offering memorandum is for general information only. No information, forward looking statements, or estimations presented herein represent any final determination on investment performance. While the information presented in this offering memorandum has been researched and is thought to be reasonable and accurate, any real estate investment is speculative in nature. Partners and/or its agents cannot and do not guarantee any rate of return or investment timeline based on the information presented herein.

By reading and reviewing the information contained in this offering memorandum, the user acknowledges and agrees that Partners and/or its agents do not assume and hereby disclaim any liability to any party for any loss or damage caused by the use of the information contained herein, or errors or omissions in the information contained in this offering memorandum, to make any investment decision, whether such errors or omissions result from negligence, accident or any other cause.

Investors are required to conduct their own investigations, analysis, due diligence, draw their own conclusions, and make their own decisions. Any areas concerning taxes or specific legal or technical questions should be referred to lawyers, accountants, consultants, brokers, or other professionals licensed, qualified or authorized to render such advice.

In no event shall Partners and/or its agents be liable to any party for any direct, indirect, special, incidental, or consequential damages of any kind whatsoever arising out of the use of this offering memorandum or any information contained herein. Partners and/or its agents specifically disclaim any guarantees, including, but not limited to, stated or implied potential profits, rates of return, or investment timelines discussed or referred to herein.

partners

PARTNERS HOUSTON

+ 512 580 6025
1360 Post Oak Blvd, Suite 1900

Houston, TX 77056

PARTNERSREALESTATE.COM

PROPERTY OVERVIEW



\$1,512,706
PRICING



8.50%
CAP RATE



\$128,586
NOI



\$41.15
RENT PER SF



\$484.07
PRICE PER SF



Absolute Net
LEASE TYPE



Corporate
GUARANTOR



Yes
RIGHT OF FIRST REFUSAL



3,125 SF
BUILDING SIZE



1.00 AC
LOT SIZE



1997
YEAR BUILT



INVESTMENT HIGHLIGHTS

LEASE STRUCTURE

Absolute Triple Net (Zero Landlord Responsibilities.)

HIGH PERFORMING LOCATION

8% rent-to-sales ratio for 2022. Current 2023 trend is on track to outperform previous year.

BEST IN CLASS OPERATOR

K-Mac Enterprises is one of the largest Taco Bell Franchisees in the nation.

ANNUAL INCREASES

Lease increases by 1% annually on January 1, 2024.

STRONG RETAIL SYNERGY

National & Regional Credit Tenants in the immediate trade area.

ADJACENT TO MERCY HOSPITAL ARDMORE

Mercy Hospital Ardmore is a full-service tertiary hospital with 190 licensed beds, a staff of nearly 1,100 and almost 100 physicians. We're southern Oklahoma's leader in providing cancer care and our Joint Replacement Center has earned The Joint Commission's Gold Seal of Approval® for its compliance with national quality and patient safety standards.

EXCELLENT REDEVELOPMENT POTENTIAL

1 AC parcel with multiple points of ingress and egress with almost 300 ft of frontage.



RENT SCHEDULE

Dates	Period	Annual Rent	Monthly Rent	Increase	Rent/SF	Cap Rate
Current - 12/31/2023	Year 19	\$128,586	\$10,715	-	\$41.15	8.50%
1/1/2024 - 12/31/2024	Year 20	\$129,872	\$10,823	1%	\$41.56	8.59%
4- 5 Year Options @ Fair Market Value	-	-	-	-	-	-



TENANT OVERVIEW



The tenant, K-Mac Enterprises, is a leading quick-service restaurant franchisee founded in 1964 and headquartered in Fayetteville, Arkansas. Over the company's 58 year history, it has grown to become one of the largest franchisee restaurant businesses in the country. K-Mac currently operates more than 320 restaurants in the Taco Bell system. The company has a regional concentration in the South Central region of the U.S., with restaurants located in Arkansas, Indiana, Illinois, Kansas, Kentucky, Missouri, Mississippi, Oklahoma, Tennessee and Texas. K-Mac currently achieves more than \$530 million in annual revenues. K-Mac continually upgrades its existing asset base while continuing to develop new stores. Going forward, K-Mac remains focused on growing through acquisitions and new unit development, as well as improving existing store operations.



FOUNDED
1964



RESTAURANTS
320+



REVENUE
\$530,000,000



HEADQUARTERS
Fayetteville, AR



PROPERTY OVERVIEW



Walmart

Popeyes

Wendy's

Mercy
Ardmore

HOBBY LOBBY
Super Savings. Super Selection!

JCPenney

CVS
pharmacy

T.J. Maxx

Walgreens

BURGER
KING

AERIAL OVERVIEW



LOCATION OVERVIEW

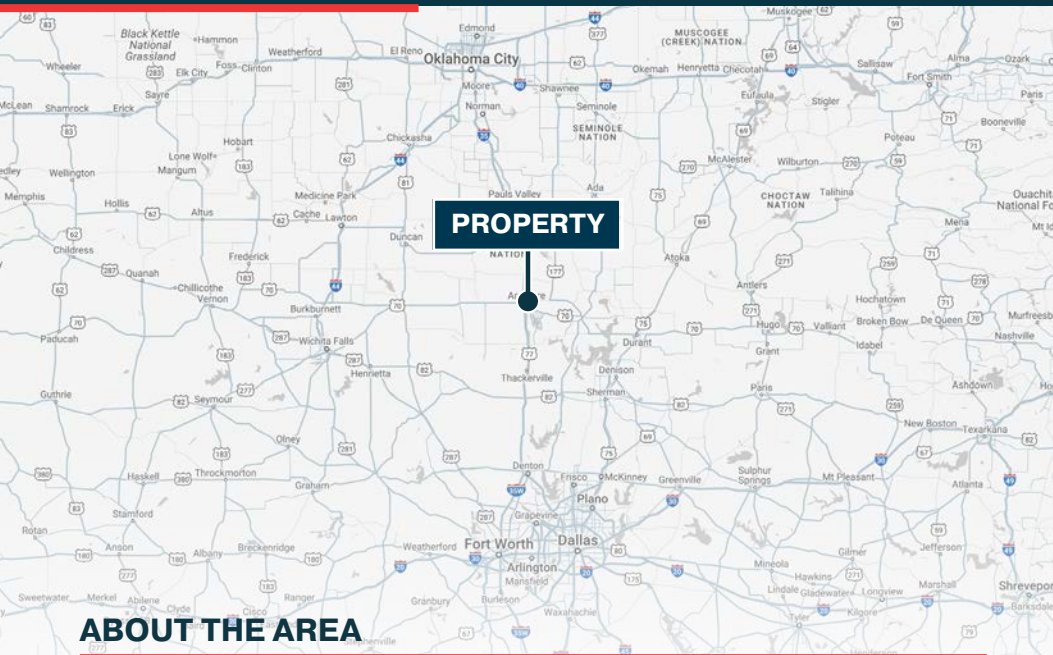

ABOUT THE AREA

Ardmore, Oklahoma is a city located in Carter County in southern Oklahoma. The city has a population of approximately 24,500 people, according to the United States Census Bureau. Ardmore is situated at the crossroads of Interstate 35 and U.S. Highway 70, which makes it a convenient location for businesses and residents.

In terms of the business community, Ardmore has a diverse mix of industries, including healthcare, manufacturing, and retail. Major employers in the city include the Mercy Hospital Ardmore, Michelin North America, and Valero Energy Corporation.

As for commercial real estate developments, Ardmore has seen significant growth in recent years. The city has several industrial parks, including the Ardmore Industrial Airpark and the Ardmore Development Authority Industrial Park, which provide space for manufacturing and distribution companies. The Ardmore Convention Center and the Ardmore Regional Park also offer opportunities for commercial development, including retail and hospitality projects.

In addition to these developments, there are several ongoing projects in Ardmore. The Ardmore Emporium is a mixed-use development that will include retail and residential space, and the Ardmore Central Park project aims to create a new public space in the heart of the city.

Overall, the commercial real estate market in Ardmore, Oklahoma is showing signs of growth and opportunity. The city's location and diverse business community make it an attractive destination for investors and developers looking for new opportunities in the southern United States.



POPULATION

2022 Population

2027 Population Projection

1 MILE 3 MILES 5 MILES

7,660 23,773 27,743

7,671 23,783 27,786



HOUSEHOLDS

2022 Households

Annual Growth 2010-2022

1 MILE 3 MILES 5 MILES

3,101 9,513 11,026

0.5% 0.3% 0.3%



HOUSEHOLD INCOME

Avg Household Income

1 MILE 3 MILES 5 MILES

\$62,202 \$64,190 \$66,128



DAYTIME EMPLOYMENT

Employees

Businesses

1 MILE 3 MILES 5 MILES

8,061 20,064 22,199

934 2,033 2,137



Jonathan Eckerd
SENIOR VICE PRESIDENT

tel 713.316.7031

jonathan.eckerd@partnersrealestate.com



Caleb Bester
ASSOCIATE

tel 713.457.1403

caleb.bester@partnersrealestate.com

partners

The information contained herein has been given to us by the owner of the property or other sources we deem reliable, we have no reason to doubt its accuracy, but we do not guarantee it. All information should be verified prior to purchase or lease.
© 2022 Partners. All rights reserved.