

OFFERING MEMORANDUM // 400 JAY SCUTTI BLVD

BJ'S WHOLESALE CLUB

WITH BJ'S GAS STATION

*PHOTOS CONTAINED WITHIN DO NOT NECESSARILY REPRESENT THE PROPERTY

BJ'S WHOLESALE CLUB

Confidentiality Agreement

This document is to be considered Marketing Material and is provided by Caliber Commercial Brokerage ("CCB"), for the consideration and opportunity to acquire the commercial property described herein (the "Property"). This Marketing Brochure may be used only as stated herein and shall not be used for any other purpose, or in any other manner, without prior written authorization and consent of CCB.

This Marketing Brochure does not constitute or pertain to an offer of a security or an offer of any investment contract. This COM contains descriptive materials, financial information and other data compiled by CCB for the convenience of parties who may be interested in the Property. Such information is not all inclusive and is not represented to include all information that may be material to an evaluation of the acquisition opportunity presented. CCB has not independently verified any of the information contained herein and makes no representations or warranties of any kind concerning the accuracy or completeness. An interested party must conduct its own independent investigation and verification of any information the party deems material to consideration of the opportunity, or otherwise appropriate, without reliance upon CCB.

The Property may be financed or withdrawn from the market without notice, and its owner(s) reserve(s) the right to negotiate with any number of interested parties at any time. The Property is offered and sold by its owner(s) as is, where is, and with all faults, without representation or warranty of any kind except for any customary warranties of title.

BY ACCEPTING THIS COM, YOU AGREE THAT: (1) all information contained herein, and all other information you have received or may hereafter receive from CCB relating to the Property, whether oral, written or in any other form (collectively, the "Information"), is strictly confidential; (2) you will not copy or reproduce, and claim as your own without attribution to CCB, all or any part of this COM or the Information; (3) for yourself and all your affiliates, officers, employees, representatives, agents and principals, you hereby release and agree to indemnify and hold harmless CCB all of its affiliates, officers, employees, representatives, agents and principals, from and with respect to any and all claims and liabilities arising from or related to the receipt or use of this COM and/or any other Information concerning the Property; (4) you will not provide this COM or any of the Information to any other party unless you first obtain such party's acceptance and approval of all terms, conditions, limitations and agreements set forth herein, as being applicable to such party as well as to you; and (5) monetary damages alone will not be an adequate remedy for a violation of these terms and that CCB shall be entitled to equitable relief, including, but not limited to, injunctive relief and specific performance, in connection with such a violation and shall not be required to post a bond when obtaining such relief.



PROPERTY NAME

**BJ's Wholesale Club
with BJ's Gas Station**



LOCATION

**400 Jay Scutti Blvd
Rochester NY 14623**



PRICE

15,100,000

***123.06 per SF**



NOI

905,738



RENT / SF*

7.38

***below market rent**



BUILDING SIZE

122,698 SF



LOT SIZE

10.68

BJ'S WHOLESALE CLUB

Summary

Caliber Commercial Brokerage is excited to present the exclusive listing for BJ's Wholesale Club with BJ's Gas station located at 400 Jay Scutti Blvd in Rochester NY. The building is 122,698 square feet and is situated on 10.68 acres. This store is located in the retail epicenter of the Rochester Market, Henrietta. With higher than average traffic counts for the area this store has continually outperformed the four other BJ's in the Rochester by leaps and bounds.

The 20-year lease term started in 2006 and includes a 5.7% rent increase every 5 years with four, 5 year options. There are currently 9 years left on the original 20 year lease with the current rent being \$905,738.

With headquarters in Westborough Mass. BJ's Wholesale Club is a leading operator of membership warehouse clubs in the Eastern United States. The company currently operates over 210 Clubs in 16 states from Maine to Florida and employs more than 25,000 Team Members.

On September 30, 2011, BJ's Wholesale Club was acquired by Beacon Holding Inc., an affiliate of Leonard Green & Partners, L.P., and funds advised by CVC Capital Partners.

BJ'S WHOLESALE CLUB WITH BJ'S GAS STATION

Investment Highlights

1

Attractive Rental Increases & Renewal Options

The rent will increase 5.7% in 2022 to \$957,436 and has four 5 year options remaining. Each 5 year option includes the same 5.7% increases when executed.

2

Corporate Guarantor

This lease is subject to a corporate guarantee, adding security through the term of the lease, through 210 corporate locations.

3

Traffic Counts

32,775 VPD (West Henrietta Rd), 31,694 (Jefferson Rd), 22,526 (Hylan Drive)

4

Strong Location

The property is in the heart of Rochester's retail corridor. Other national retailers in the area include Panera, Red Lobster, The Home Depot, PetSmart, Taco Bell, Target, Wegmans, Lowes, Sam's Club, Walmart, Chili's and MacDonald's to name a few.

5

Long Term Lease

With 9 years remaining on original lease

6

20 Years w/ 4, 5 Year Extensions

5.7% increases in rent every 5 years

7

Passive Investment Opportunity

A triple net lease provides passive income opportunity for a prospective buyer with the areas top performing store.

8

Parking

552 spots



Tenant Overview

BJ's Wholesale Club Inc., commonly referred to as BJ's, is a membership-only warehouse club chain operating on the East coast and Ohio. The company was founded in 1984 in Massachusetts and was recently acquired by Beacon Holding Inc., an affiliate of Leonard Green & Partners, L.P., and funds advised by CVC Capital Partners.

BJ's core members make between \$75,000 and \$90,000 a year and groceries account for 75% of sales with the remaining coming from general merchandise including apparel, housewares, office equipment small appliances and gas.

2017 marked the launch of BJ's B2B Sales Division which is part of an overall growth plan started in 2011 to capture a larger share of the market place from its largest competitors Costco and Sam's Club. An additional part of BJ's growth strategy is to increase its Fresh Food footprint within its stores. This has resulted in BJ's selling 50% more fresh food per member per year than its closest competitors.

Their growth strategies are paying off resulting in an 85.5 percent renewal rate of its memberships. Which out paces Sam's Club and tightens the gap between Costco and itself.

FINANCIAL OFFERING

BJ's Wholesale Club with BJ's Gas Station



PROPERTY TYPE

**Net Leased
Retail Store**



OWNERSHIP

**Private
Equity**



TENANT

**BJ's Wholesale
Club**



LEASE COMMENCEMENT

**January 21
2006**



LEASE EXPIRATION

**January 21
2026**



LEASE TERM REMAINING

**Nine
Years**



LEASE TYPE

**Triple-Net
(NNN)**



OPTIONS TO REVIEW

**Four, Five Year
Option Periods**



RENTAL INCREASES

**5.7% Every Five Years
From Date Of
Commencement**



Location Details

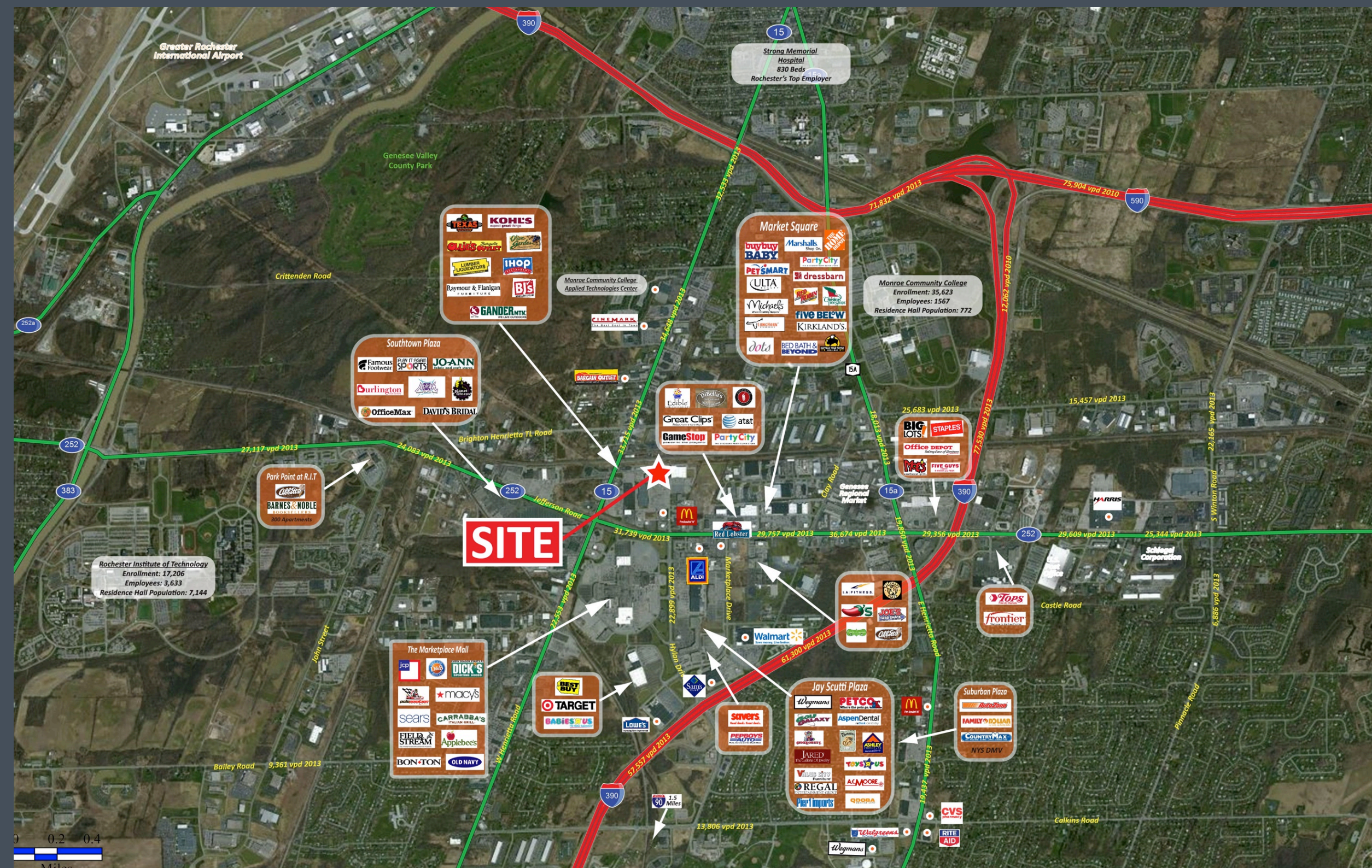
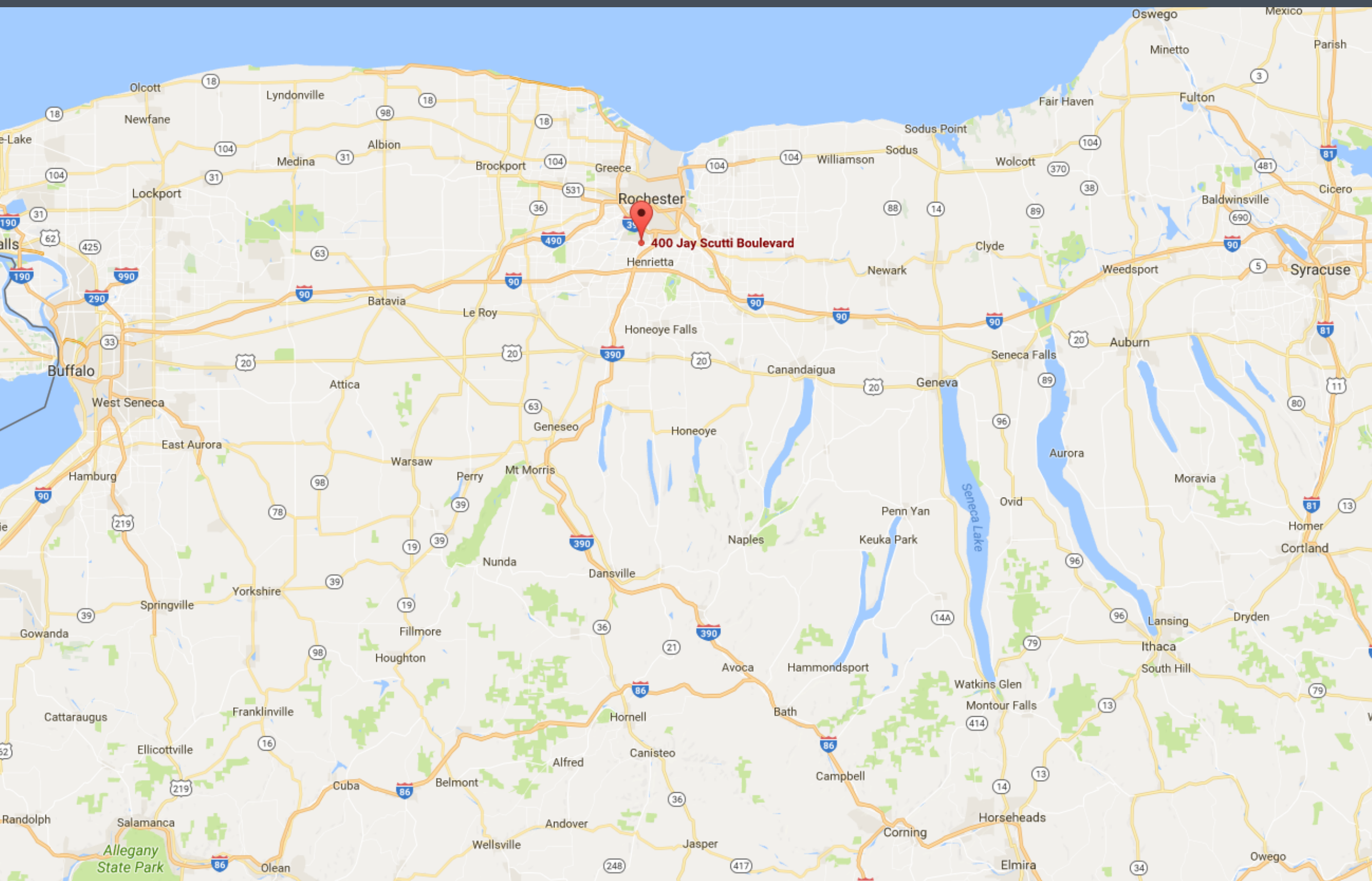

Regional



BJ'S WHOLESALE CLUB

Location Details

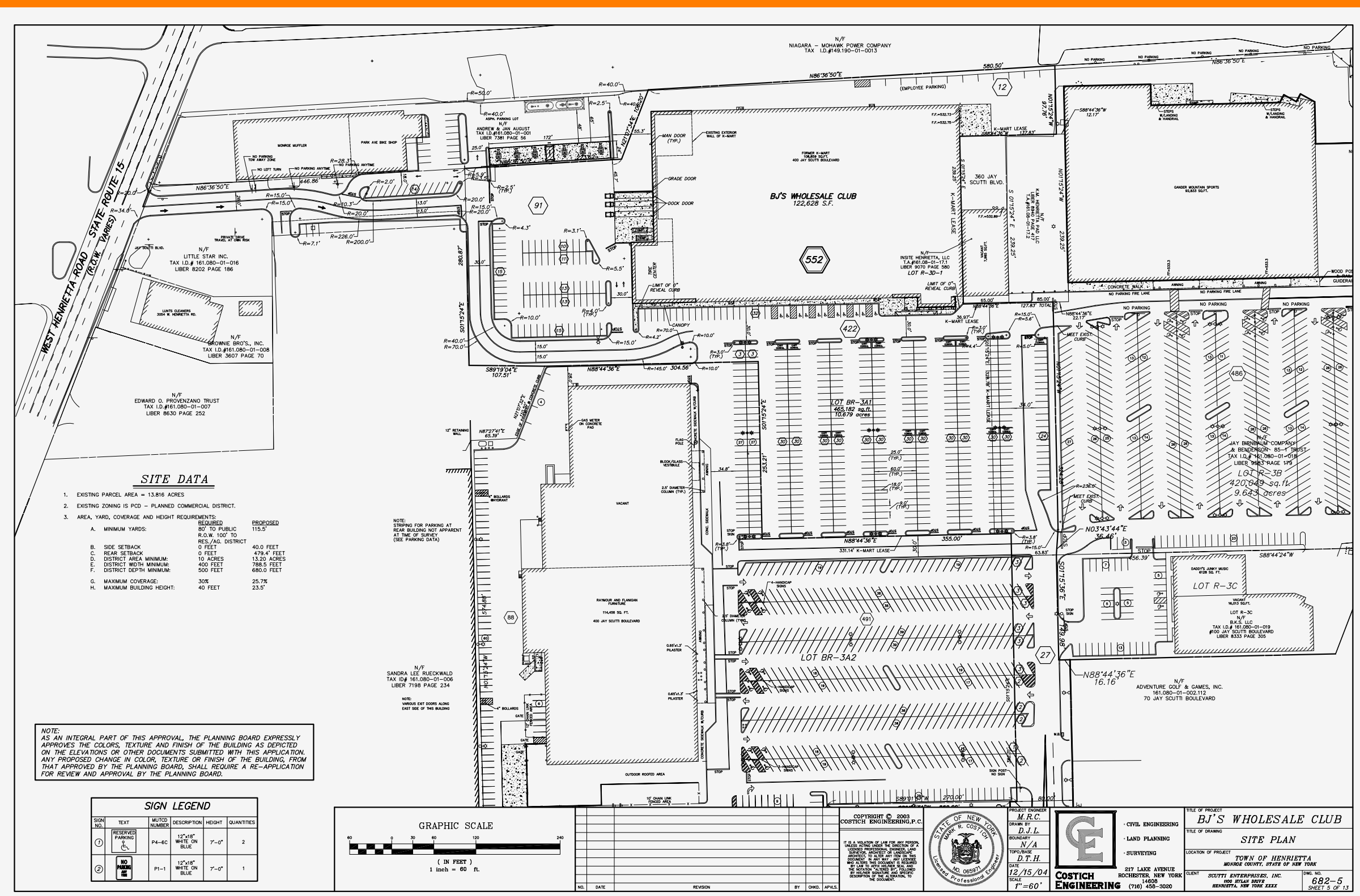

Site Plan



Property Outline

***TAX MAP AVAILABLE UPON REQUEST**

THANK YOU!

Get in Touch With Us

Matt Lester
Managing Partner, Associate Broker
mlester@caliberbrokerage.com

Caliber Commercial Brokerage, LCC
1657 East Ave
Rochester, NY 14610
585.454.4500

